

Introduction

Product Facts

- Terminal is made of high conductivity copper, electro tin plated for improved corrosion resistance.
- Serrated inner wire barrel provides maximum electrical contact and tensile strength after crimping.
- Conical entry of the wire barrel allows easier insertion of the stripped wire.
- Expanded vinyl insulation sleeve to accept a wide range of wire insulation diameters.
- Insulation sleeves and corresponding tooling are color-coded by wire range for easier identification.
- A variety of PLASTI-GRIP terminals and splices are UL listed File E 13288 and certified by CSA File LR 7189.

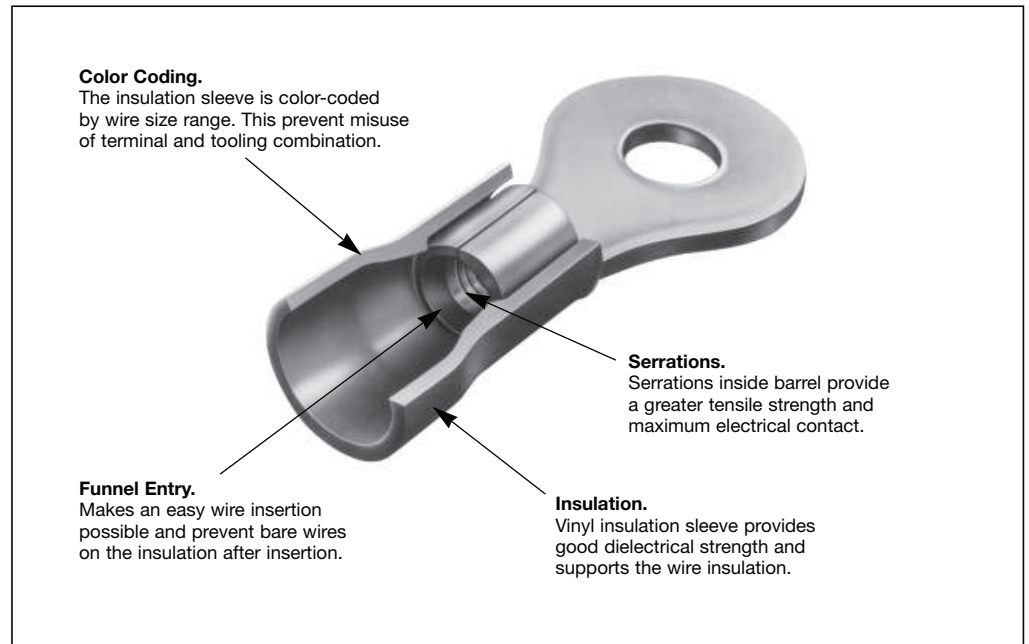

Pre-insulated PLASTI-GRIP solderless terminals and splices have been designed specifically to answer the need for inexpensive, insulated electrical terminations.

The appeal of PLASTI-GRIP products lies in their broad range of wire sizes, built-in pre-insulation, ease and speed of application, uniform reliability and low installed cost.

They can be used in almost every type of industrial or commercial applications.

As true of all Tyco Electronics terminals and splices lines, carefully engineered application tooling has been developed for the PLASTI-GRIP program to ensure uniformly high quality terminations.

Terminal and insulation sleeve are simultaneously crimped. A pre-insulated connection of great tensile strength is achieved. The most advanced terminal is useless, if incorrectly crimped.

Tyco Electronics has designed the tool and terminal as a team to achieve ease and speed of application and to provide a precise crimping for every wire size. The crimped insulation sleeve provides a degree of support to the wire.

A wide range of professional hand tools, with a patented ratchet device to ensure the crimp cycle is completed before releasing, are available.

The insulation sleeve is dot coded during crimping. In combination with the wire size on the tongue and the sleeve color it offers a built-in quality control factor.

For large production runs pneumatic or electrical tooling is available. A range of service tools completes the tooling program of Tyco Electronics.



AWG Identification Numbers

The International AWG Identification Numbers

Each Tyco Electronics Terminal and Splice covers specific international wire range and has the applicable wire size marked on the tongue or the barrel. Insulated terminals and splices are color coded for easy identification. All application tools have a special matching control system.

With this technique the quality of the termination made can be reliably checked at any time. During crimping the application tooling marks a proper visual code on the terminal or insulation sleeve. If the code of the terminal and the mark of the tool are corresponding, a reliable termination with the correct tooling has been made.

Cross Reference of AWG Code Numbers to Wire Size Range

AWG Code Number	Wire Size Range (mm ²)	for DIN Cross Section (mm ²)
26-22	0.10- 0.40	0.14/0.20/0.25/0.35
22-16	0.25- 1.60	0.35/0.50/0.75/1.00/1.50
16-14	1.00- 2.60	1.00/1.50/2.50
16-14 HD*	1.00- 2.60	1.00/1.50/2.50
12-10	2.70- 6.60	4.00/6.00
8	6.70- 10.50	10.0
6	10.60- 16.70	16.0
4	16.80- 26.60	25.0
2	26.70- 42.40	35.0
1/0	42.50- 60.50	50.0
2/0	60.60- 76.20	70.0
3/0	76.30- 97.00	95.0
4/0	98.00-120.00	120.0
250-300 MCM	121.00-151.00	150.0
300-350 MCM	152.00-192.00	185.0
400-350 MCM	193.00-242.00	240.0
500-600 MCM	243.00-304.00	300.0

*) Heavy-duty terminals use AWG 12-10 (2.7-6.6 mm²) tooling.

Minimum Number of Wires, Diameter of Conductor for Insulated High Current Conductors

Wire Size Range (mm ²)	Number and Diameter of Wires (mm)	Diameter of Conductor (mm)	Wire Size Range (mm ²)	Number and Diameter of Wires (mm)	Diameter of Conductor (mm)
0.14	1 x 0.42	0.42	25.0	1 x 5.64	5.64
	18 x 0.10	-		7 x 2.13	6.40
	8 x 0.15	-		84 x 0.62	7.70
0.20	1 x 0.50	0.50	35.0	200 x 0.40	7.50
	11 x 0.15	-		797 x 0.20	7.60
	26 x 0.10	-		19 x 1.53	7.70
0.25	1 x 0.60	0.60	50.0	133 x 0.58	8.70
	14 x 0.15	-		280 x 0.40	8.70
	1 x 0.67	0.67		1115 x 0.20	9.00
0.35	7 x 0.26	0.80	70.0	19 x 1.83	9.20
	12 x 0.21	0.90		133 x 0.69	10.40
	1 x 0.80	0.80		400 x 0.40	11.00
0.50	7 x 0.30	0.90	95.0	1592 x 0.20	11.00
	16 x 0.21	1.00		19 x 2.17	11.00
	1 x 1.00	1.00		189 x 0.69	12.70
0.75	24 x 0.20	1.20	120.0	560 x 0.40	12.00
	1 x 1.13	1.13		1427 x 0.25	12.50
	32 x 0.20	1.30		19 x 2.52	12.60
1.00	1 x 1.38	1.38	150.0	259 x 0.69	14.50
	7 x 0.52	1.60		485 x 0.50	14.90
	30 x 0.25	1.60		1936 x 0.25	14.90
1.50	1 x 1.78	1.78	185.0	37 x 2.03	14.20
	7 x 0.67	2.00		336 x 0.67	16.40
	50 x 0.25	2.10		614 x 0.50	16.00
2.50	1 x 2.26	2.26	240.0	2445 x 0.25	16.40
	19 x 0.52	2.60		37 x 2.26	15.80
	56 x 0.30	2.80		392 x 0.69	18.00
4.00	1 x 2.26	2.26	300.0	765 x 0.50	19.20
	19 x 0.64	3.20		2123 x 0.30	19.30
	84 x 0.30	3.50		37 x 2.52	18.00
6.00	1 x 3.57	3.57	350.0	494 x 0.69	19.00
	7 x 1.35	4.10		944 x 0.44	20.00
	49 x 0.51	4.60		2618 x 0.30	21.00
10.00	80 x 0.40	5.00	400.0	61 x 2.24	20.50
	1 x 4.52	4.52		627 x 0.69	22.00
	7 x 1.70	5.10		1225 x 0.50	23.00
16.00	49 x 0.65	5.90	450.0	3396 x 0.30	24.00
	127 x 0.40	6.00		61 x 2.50	23.00
				790 x 0.69	25.00
			1530 x 0.50	27.00	

Ring Tongue Terminals

Material and Finish

Insulation:

Vinyl acc. UL 94 V-0

Terminal Body:

Copper per ASTM B-152

Plating:

Tin per ASTM B-545

Style A

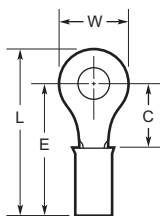

Wire Size AWG (mm ²)	Tongue Material Thickness Max.	Stud Size	Style	Dimensions				Terminal Insulation Color	Wire Insulation Diameter Max.	Part Numbers	
				W	C Min.	E Max.	L Max.			Loose- Piece	Tape Mounted
22-16 (0.26-1.65)	.033 0.84	2 M2	A	.218	.156	.572	.684	●	.140	34140	2-34140-1
				5.54	3.96	14.53	17.37	●	3.56	-	-
		4	A	.218	.156	.572	.684	●	.125	32944	-
				5.54	3.96	14.53	17.37	●	3.18	-	2-34141-1
				.281	.250	.666	.809	●	.140	34143	2-34143-1
				7.14	6.35	16.92	20.55	●	3.56	-	-
		6 M3.5	A	.218	.156	.572	.684	●	.125	32945	2-32945-1
				5.54	3.96	14.53	17.37	●	3.18	-	1-34142-1
				.281	.250	.666	.809	●	.125	-	2-32947-1
				7.14	6.35	16.92	20.55	●	3.18	-	-
				.281	.250	.666	.809	●	.140	34144	-
				7.14	6.35	16.92	20.55	●	3.56	-	2-326819-1
16-14 (1.04-2.62)	.033 0.84	8 M4	A	.312	.281	.697	.856	●	.125	-	2-32950-1
				7.92	7.14	17.70	21.74	●	3.18	-	-
				.312	.281	.697	.856	●	.140	34147	-
				7.92	7.14	17.70	21.74	●	3.56	-	-
		10	A	.281	.250	.666	.809	●	.125	32948	2-32948-1
				7.14	6.35	16.92	20.55	●	3.18	-	-
				.281	.250	.666	.809	●	.140	34145	2-34145-1
				7.14	6.35	16.92	20.55	●	3.56	-	-
		1/4 M6	A	.312	.281	.697	.856	●	.125	32951	-
				7.92	7.14	17.70	21.74	●	3.18	-	-
		5/16 M8	A	.312	.281	.697	.856	●	.140	34148	-
				7.92	7.14	17.70	21.74	●	3.56	-	-
3/8	A	.281	.250	.666	.809	●	.140	34146	2-34146-1		
		7.14	6.35	16.92	20.55	●	3.56	-	2-34146-5		
4	A	.312	.281	.697	.856	●	.125	32952	2-32952-1		
		7.92	7.14	17.70	21.74	●	3.18	-	2-32953-1		
4	A	.469	.437	.853	1.090	●	.125	-	2-32953-1		
		11.91	11.10	21.67	27.69	●	3.18	-	-		
		.469	.437	.853	1.090	●	.140	34150	-		
		11.91	11.10	21.67	27.69	●	3.56	-	-		
		.469	.437	.853	1.090	●	.140	34151	2-34151-1		
		11.91	11.10	21.67	27.69	●	3.56	-	-		
3/8	A	.531	.546	.962	1.230	●	.140	34152	2-34152-2		
		13.49	13.87	24.43	31.24	●	3.56	-	-		
16-14 (1.04-2.62)	.033 0.84	6 M3.5	A	.250	.171	.587	.715	●	.170	34157	-
				6.35	4.34	14.91	18.16	●	4.32	-	-
		6 M3.5	A	.250	.171	.587	.715	●	.170	-	2-34158-1
				6.35	4.34	14.91	18.16	●	4.32	-	-
				.343	.281	.697	.871	●	.145	-	2-32958-1
				8.71	7.14	17.70	22.12	●	3.68	-	-
6 M3.5	A	.343	.281	.697	.871	●	.170	34159	2-34159-1		
		8.71	7.14	17.70	22.12	●	4.32	-	-		

Note: "C" dimension applies from edge of metal wire barrel to centre of stud hole (styles A & E).

Ring Tongue Terminals (continued)

Material and Finish

Insulation:

Vinyl acc. UL 94 V-0

Terminal Body:

Copper per ASTM B-152

Plating:

Tin per ASTM B-545

Wire Size AWG (mm ²)	Tongue Material Thickness Max.	Stud Size	Style	Dimensions				Terminal Insulation Color	Wire Insulation Diameter Max.	Part Numbers		
				W	C Min.	E Max.	L Max.			Loose- Piece	Tape Mounted	
16-14 (1.04-2.62)	.033 0.84	8 M4	A	.312	.250	.666	.825	Blue	.170	328527	2-328527-1	
				7.92	6.35	16.92	20.96	Blue	4.32			
				.343	.281	.697	.871	Blue	.145	32959	2-32959-1	
		8.71	7.14	17.70	22.12	Blue	3.68					
		.343	.281	.697	.871	Blue	.170	34160	2-34160-1			
		8.71	7.14	17.70	22.12	Blue	4.32					
	10	A	A	.343	.281	.697	.871	Blue	.145	-	2-32960-1	
				8.71	7.14	17.70	22.12	Blue	3.68			
				.469	.437	.853	1.090	Blue	.145	32961	-	
	11.91	11.10	21.67	27.69	Blue	3.68						
	1/4 M6	A	A	.469	.437	.853	1.090	Blue	.170	34162	-	
				11.91	11.10	21.67	27.69	Blue	4.32			
.469				.437	.853	1.090	Blue	.170	34163	2-34163-1		
11.91	11.10	21.67	27.69	Blue	4.32							
5/16 M8	A	A	.531	.546	.962	1.248	Blue	.170	34164	2-34164-2		
			13.49	13.87	24.43	31.70	Blue	4.32				
			.531	.546	.962	1.248	Black	.170	-	2-34164-4		
13.49	13.87	24.43	31.70	Black	4.32							
16-14HD** (1.04-2.62)	.050 1.27	10	A	.343	.281	.872	1.046	Yellow/Black	.200	-	2-34823-1*	
				8.71	7.14	22.15	26.57	Yellow/Black	5.08			
				.343	.281	.872	1.046	Yellow/Black	.250	-	2-321518-1	
		8.71	7.14	22.15	26.57	Yellow/Black	6.35					
		1/4 M6	A	A	.500	.344	.935	1.188	Yellow/Black	.230	35349	-
					12.70	8.74	23.75	30.18	Yellow/Black	5.84		
.531	.437				1.028	1.296	Yellow/Black	.200	34824	-		
13.49	11.10	26.11	32.92	Yellow/Black	5.08							
3/8	A	A	.750	.625	1.216	1.594	Yellow/Black	.200	34826	-		
			19.05	15.88	30.89	40.49	Yellow/Black	5.08				
			.281	.219	.810	.953	Yellow	.250	34852	-		
7.14	5.56	20.57	24.21	Yellow	6.35							
6 M3.5	A	A	.375	.302	.893	1.098	Yellow	.230	34168	-		
			9.53	7.67	22.68	27.89	Yellow	5.84				
10	A	A	.312	.302	.953	1.111	Yellow	.300	-	1-330518-2		
			7.92	7.67	24.21	28.22	Yellow	7.62				
			.375	.302	.893	1.083	Black	.250	-	2-328261-1		
		9.53	7.67	22.68	27.51	Black	6.35					
		.375	.302	.893	1.098	Yellow	.250	34854	2-34854-1			
		9.53	7.67	22.68	27.89	Yellow	6.35					
12-10 (2.62-6.64)	.042 1.07	1/4 M6	E	.400	.468	1.118	1.373	Yellow	.300	-	55678-2	
				10.16	11.89	28.40	34.87	Yellow	7.62			
				.500	.344	.994	1.247	Black	.300	35492	-	
12.70	8.74	25.25	31.67	Black	7.62							
5/16 M8	A	A	.531	.468	1.059	1.327	Yellow	.250	34855	2-34855-1		
			13.49	11.89	26.90	33.71	Yellow	6.35				
			.531	.468	1.059	1.327	Yellow	.230	34172	2-34172-1		
13.49	11.89	26.90	33.71	Yellow	5.84							
3/8	A	A	.531	.468	1.059	1.327	Yellow	.250	34856	2-34856-1		
			13.49	11.89	26.90	33.71	Yellow	6.35				
1/2 M12	A	A	.593	.531	1.122	1.421	Yellow	.230	-	2-34173-1		
			15.06	13.49	28.50	36.09	Yellow	5.84				
1/2 M12	A	A	.750	.625	1.216	1.594	Yellow	.250	34837	2-34837-4		
			19.05	15.88	30.89	40.49	Yellow	6.35				

Style A

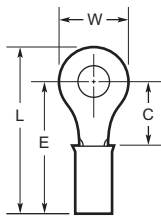

Style E

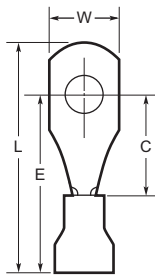

*) Not UL or CSA Approved or Listed.

***) Heavy duty for extra mechanical strength.

Note: "C" dimension applies from edge of metal wire barrel to centre of stud hole (styles A & E).

Ring Tongue Terminals (continued)

Material and Finish

Insulation:

Vinyl acc. UL 94 V-0

Terminal Body:

Copper per ASTM B-152

Plating:

Tin per ASTM B-545

Style A

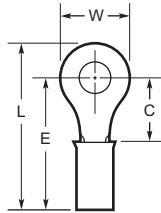

Style B

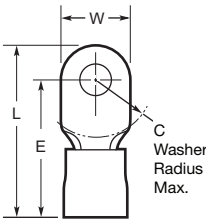

Style C

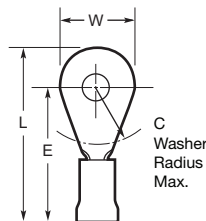

Style F

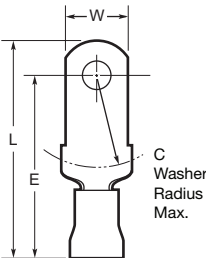

Wire Size AWG (mm ²)	Tongue Material Thickness Max.	Stud Size	Style	Dimensions				Terminal Insulation Color	Wire Insulation Diameter Max.	Part Numbers	
				W	C Min.	E Max.	L Max.			Loose- Piece	Tape Mounted
8 (6.64-10.5)	.043 1.09	8 M4	C	.478	.437	1.344	1.586	●	.360 9.14	52041	1-52041-6
				12.14	11.10	34.14	40.28				
			B	.431	.437	1.338	1.556	●	.360 9.14	52263	1-52263-2
				10.95	11.10	33.99	39.52				
		10	B	.431	.437	1.338	1.556	●	.390 9.91	-	1-52263-4
				10.95	11.10	33.99	39.52				
		1/4 M6	C	.431	.437	1.303	1.561	●	.360 9.14	-	1-55621-2
				10.95	11.10	33.10	39.65				
		5/16 M8	C	.478	.437	1.344	1.586	●	.360 9.14	52041-1	52041-7
				12.14	11.10	34.14	40.28				
		3/8	C	.478	.437	1.358	1.600	●	.330 8.38	52041-3	52041-9
				12.14	11.10	34.49	40.64				
1/2 M12	A	.587	.500	1.400	1.696	●	.360 9.14	52291	52291-4		
		14.91	12.70	35.56	43.08						
8 M4	C	.587	.500	1.400	1.696	●	.360 9.14	52291-1	52291-5		
		14.91	12.70	35.56	43.08						
10	B	.875	.625	1.420	1.860	●	.330 8.38	52262-1	-		
		22.23	15.88	36.07	47.24						
8 M4	C	.500	.515	1.591	1.869	●	.360 9.14	52042-2	-		
		12.70	13.08	40.41	47.47						
10	B	.468	.421	1.482	1.719	●	.436 11.07	52265	52265-3		
		11.89	10.69	37.64	43.66						
1/4 M6	C	.500	.515	1.591	1.844	●	.436 11.07	52042-4	-		
		12.70	13.08	40.41	46.84						
5/16 M8	B	.398	.515	1.591	1.846	●	.450 11.43	-	55679-2		
		10.11	13.08	40.41	46.89						
6 (10.5-16.8)	.046 1.22	1/4 M6	C	.500	.515	1.591	1.844	●	.436 11.07	52042-1	-
				12.70	13.08	40.41	46.84				
5/16 M8	B	.500	.515	1.591	1.869	●	.360 9.14	52042-3	-		
		12.70	13.08	40.41	47.47						
3/8	B	.625	.515	1.591	1.906	●	.450 11.43	52264	52264-4		
		15.88	13.08	40.41	48.41						
1/2 M12	C	.625	.515	1.591	1.906	●	.450 11.43	52264-1	52264-5		
		15.88	13.08	40.41	48.41						
10	B	.815	.515	1.441	1.851	●	.436 11.07	52350	-		
		20.70	13.08	36.60	47.02						
1/4 M6	B	.546	.531	1.672	1.948	●	.450 11.43	52043-2	-		
		13.87	13.49	42.47	49.48						
5/16 M8	B	.391	.531	1.672	1.927	●	.450 11.43	-	55680-2		
		9.93	13.49	42.47	48.95						
3/8	B	.546	.531	1.672	1.948	●	.450 11.43	52043-3	-		
		13.87	13.49	42.47	49.48						
4 (16.8-26.7)	.051 1.30	1/4 M6	B	.546	.531	1.672	1.948	●	.515 13.08	52043-1	-
				13.87	13.49	42.47	49.48				
5/16 M6	B	.679	.531	1.672	2.014	●	.450 11.43	52266-3	-		
		17.25	13.49	42.47	51.16						
3/8	B	.679	.531	1.672	2.014	●	.450 11.43	52266-4	-		
		17.25	13.49	42.47	51.16						
5/16 M6	B	.679	.531	1.672	2.014	●	.515 13.08	52266-1	-		
		17.25	13.49	42.47	51.16						

Ring Tongue Terminals (continued)

Material and Finish

Insulation:

Vinyl acc. UL 94 V-0

Terminal Body:

Copper per ASTM B-152

Plating:

Tin per ASTM B-545

Style B

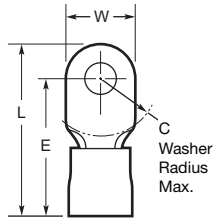

Wire Size AWG (mm ²)	Tongue Material Thickness Max.	Stud Size	Style	Dimensions				Terminal Insulation Color	Wire Insulation Diameter Max.	Part Numbers	
				W	C Min.	E Max.	L Max.			Loose- Piece	Tape Mounted
1/0 (26.7-42.4)	.060 1.52	1/4 M6	B	.675	.578	1.731	2.071	●	.560 14.22	52267-1	-
				17.15	14.68	43.97	52.60				
		5/16 M8	B	.675	.578	1.731	2.071	●	.632 16.05	52267	-
				17.15	14.68	43.97	52.60				
1/0 (42.4-60.6)	.073 1.85	5/16 M8	B	.711	.578	1.731	2.089	●	.632 16.05	52044-1	-
				18.06	14.68	43.97	53.06				
		3/8	B	.711	.578	1.731	2.089	●	.632 16.05	52044-2	-
				18.06	14.68	43.97	53.06				
5/16 M8	B	.807	.625	2.041	2.447	●	.684 17.37	52045-1	-		
		20.50	15.88	51.84	62.15						
3/8	B	.807	.625	2.041	2.447	●	.665 16.89	52045-5	-		
		20.50	15.88	51.84	62.15						

Ring Tongue 90° Bent Terminals

Material and Finish

Insulation:

Nylon

Terminal Body:

Copper per ASTM B-152

Plating:

Tin per ASTM B-545

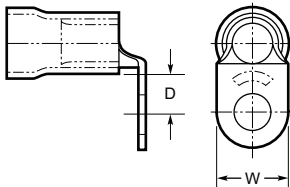

Wire Size AWG (mm ²)	Tongue Material Thickness Max.	Stud Size	Dimensions		Terminal Insulation Color	Wire Insulation Diameter Range	Part Numbers	
			W	C Min.			Loose- Piece	Tape Mounted
8 (6.64-10.5)	.043 1.09	10	.431 10.95	.311 7.90	●	.360 9.14	55654-1	-
6 (10.5-16.8)	.048 1.22	10	.500 12.70	.310 7.87	●	.436 11.07	54753-1	-
		1/4 M6	.500 12.70	.379 9.63	●	.436 11.07	54754-1	-

Spade Tongue Terminals

Material and Finish

Insulation:

Vinyl acc. UL 94 V-0

Terminal Body:

Copper per ASTM B-152

Plating:

Tin per ASTM B-545

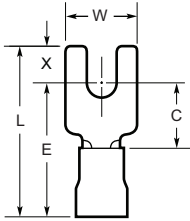

Wire Size AWG (mm ²)	Tongue Material Thickness Max.	Stud Size	Dimensions					Terminal Insulation Color	Wire Insulation Diameter Max.	Part Numbers					
			W	C Min.	E Max.	L Max.	X			Loose- Piece	Tape Mounted				
22-16 (0.26-1.65)	.033 0.84	6 M3.5	.250	.312	.728	.858	.125	●	.140 3.56	327043	2-327043-1				
			6.35	7.92	18.49	21.79	3.18								
		8 M4	.297	.203	.619	.765	.141	●	.125 3.18	327735	2-327735-1				
			7.54	5.16	15.72	19.43	3.58								
			.297	.203	.619	.765	.141					●	.140 3.56	-	2-320665-1
			7.54	5.16	15.72	19.43	3.58								
10	.375	.312	.728	.920	.187	●	.120 3.18	32981	-						
	9.53	7.92	18.49	23.37	4.75										
	.375	.312	.728	.920	.187					●	.140 3.56	34155	2-34155-1		
9.53	7.92	18.49	23.37	4.75											
16-12 (1.04-2.62)	.033 0.84	6 M3.5	.297	.203	.619	.765	.141	●	.145 3.68	322994	2-322994-1				
		7.54	5.16	15.72	19.43	3.58									
10	.033 0.84	10	.385	.312	.728	.920	.187	●	.170 4.32	-	2-34167-1				
			9.78	7.92	18.49	23.37	4.75								
12-10 (2.62-6.64)	.042 1.07	10	.406	.296	.887	1.095	.203	●	.230 5.84	-	2-34176-1				
			10.31	7.52	22.53	27.81	5.16								

Note: "C" dimension applies from edge of metal wire barrel to centre of stud hole.

Flanged Spade Tongue Terminals

Material and Finish

Insulation:

Vinyl acc. UL 94 V-0

Terminal Body:

Copper per ASTM B-152

Plating:

Tin per ASTM B-545

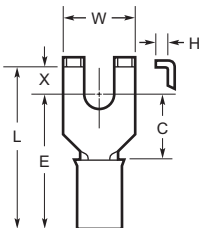

Wire Size AWG (mm ²)	Tongue Material Thickness Max.	Stud Size	Dimensions						Terminal Insulation Color	Wire Insulation Diameter Max.	Part Numbers					
			W	C Min.	E Max.	L Max.	X	H Min.			Loose- Piece	Tape Mounted				
22-16 (0.26-1.65)	.033 0.84	6 M3.5	.296	.203	.619	.749	.125	.045	●	.140 3.56	322249	1-322249-1				
			7.52	5.16	15.72	19.02	3.18	1.14								
		8 M4	.296	.203	.619	.749	.125	.045	●	.140 3.56	1-322249-0	1-322249-9				
			7.52	5.16	15.72	19.02	3.18	1.14								
			.416	.250	.666	.842	.171	.062					●	.140 3.56	324169	-
			10.57	6.35	16.92	21.39	4.34	1.57								
10	.033 0.84	10	.296	.203	.619	.749	.125	.045	●	.140 3.56	328516	2-328516-1				
			7.52	5.16	15.72	19.02	3.18	1.14								
			16-24 (1.04-2.62)	.033 0.84	6 M3.5	.294	.203	.619					.749	.125	.047	●
7.47	5.16	15.72			19.02	3.18	1.19									
12-10 (2.62-6.64)	.042 1.07	8 M4	.294	.203	.619	.749	.125	.047	●	.170 4.32	-	53874-2				
			7.47	5.16	15.72	19.02	3.18	1.19								
		10	.042 1.07	6 M3.5	.296	.250	.841	1.017	.171	.052	●	.230 5.84	324581	1-324581-1		
					7.52	6.35	21.36	25.83	4.34	1.32						
				8 M4	.416	.250	.841	1.017	.171	.052	●	.230 5.84	-	1-324172-0		
					10.57	6.35	21.36	25.83	4.34	1.32						
10	.042 1.07	10	.416	.250	.841	1.017	.171	.052	●	.250 6.35	-	52856-1				
			10.57	6.35	21.36	25.83	4.34	1.32								

Note: "C" dimension applies from edge of metal wire barrel to centre of stud hole.

Short Spring Spade Tongue Terminals

Material and Finish

Insulation:

Vinyl acc. UL 94 V-0

Terminal Body:

Phosphor Bronze per ASTM B-139 for wire sizes 24 to 14, Brass per ASTM B-36 for wire sizes 12 to 10

Plating:

Tin per ASTM B-545 except where noted

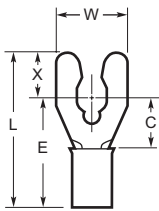

Wire Size AWG (mm ²)	Tongue Material Thickness Max.	Stud Size	Dimensions					Terminal Insulation Color	Wire Insulation Diameter Max.	Part Numbers			
			W	C Min.	E Max.	L Max.	X			Loose- Piece	Tape Mounted		
24-20 (0.16-0.65)	.025 0.64	4	.203	.219	.624	.744	.115	○	.125	-	53829-2		
			5.16	5.56	15.85	18.90	2.92						
		4	.203	.250	.666	.811	.140	●	.140	52947	52947-1		
			5.16	6.35	16.92	20.60	3.56						
		6	.234	.250	.666	.811	.140	●	.140	53240-1	53240-2		
			5.94	6.35	16.92	20.60	3.56						
		M3.5	.250	.250	.666	.811	.140	●	.140	52949	52949-1		
			6.35	6.35	16.92	20.60	3.56						
		M3.5	.250	.250	.715	.860	.140	●	.200	-	52949-3		
			6.35	6.35	18.16	21.84	3.56						
		22-16 (0.26-1.65)	.033 0.84	8	.244	.281	.697	.872	.170	●	.140	53241-1	53241-2
					6.20	7.14	17.70	22.15	4.32				
M4	.375			.281	.697	.872	.170	●	.140	52950	52950-1		
	9.53			7.14	17.70	22.15	4.32						
M4	.294			.281	.697	.920	.218	●	.140	53242-1	53242-2		
	7.47			7.14	17.70	23.37	5.54						
10	.294			.281	.746	.969	.218	●	.200	-	53242-6		
	7.47			7.14	18.95	24.61	5.54						
10	.406			.281	.697	.920	.218	●	.140	-	52951-1		
	10.31			7.14	17.70	23.37	5.54						
10	.406			.281	.746	.969	.218	●	.200	-	52951-3		
	10.31			7.14	18.95	24.61	5.54						
16-14 (1.04-2.62)	.033 0.84	6	.250	.250	.666	.811	.140	●	.170	52955	52955-1		
			6.35	6.35	16.92	20.60	3.56						
		M3.5	.250	.250	.715	.860	.140	●	.250	52955-2	52955-3		
			6.35	6.35	18.16	21.84	3.56						
		8	.244	.281	.697	.872	.170	●	.170	53244-1	53244-2		
			6.20	7.14	17.70	22.15	4.32						
		M4	.375	.281	.697	.872	.170	●	.170	52956	52956-1		
			9.53	7.14	17.70	22.15	4.32						
		M4	.294	.281	.697	.920	.218	●	.170	53245-1	53245-2		
			7.47	7.14	17.70	23.37	5.54						
		10	.294	.281	.746	.969	.218	●	.250	-	53245-6		
			7.47	7.14	18.95	24.61	5.54						
10	.406	.281	.697	.920	.218	●	.170	52957	52957-1				
	10.31	7.14	17.70	23.37	5.54								
10	.406	.281	.746	.969	.218	●	.250	-	52957-3				
	10.31	7.14	18.95	24.61	5.54								
12-10 (2.62-6.64)	.042 1.07	6	.250	.174	.775	.959	.179	●	.200	52961	52961-1		
			6.35	4.42	19.69	24.36	4.55						
		M3.5	.250	.174	.775	.959	.179	●	.250	53246-1	-		
			6.35	4.42	19.69	24.36	4.55						
		8	.312	.276	.877	1.052	.170	●	.250	53247-1	53247-2		
			7.92	7.01	22.28	26.72	4.32						
		M4	.375	.276	.877	1.052	.170	●	.200	52962	52962-1		
			9.53	7.01	22.28	26.72	4.32						
		10	.406	.276	.877	1.100	.218	●	.200	52963	52963-1		
			10.31	7.01	22.28	27.94	5.54						
		10	.406	.276	.936	1.159	.218	●	.300	-	52963-5		
			10.31	7.01	23.77	29.44	5.54						

Note: "C" dimension applies from edge of metal wire barrel to centre of stud hole.

Long Spring Spade Tongue Terminals

Material and Finish

Insulation:

Vinyl acc. UL 94 V-0

Terminal Body:

Phosphor Bronze per ASTM B-139 for wire sizes 24 to 14, Brass per ASTM B-36 for wire sizes 12 to 10

Plating:

Tin per ASTM B-545 except where noted

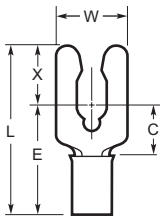

Wire Size AWG (mm ²)	Tongue Material Thickness Max.	Stud Size	Dimensions					Terminal Insulation Color	Wire Insulation Diameter Max.	Part Numbers	
			W	C Min.	E Max.	L Max.	X			Loose- Piece	Tape Mounted
22-16 (0.26-1.65)	.033 0.84	6 M3.5	.250 6.35	.238 6.05	.664 16.87	.945 24.00	.276 7.01	●	.140 3.56	52453	52453-1
		8 M4	.281 7.14	.270 6.86	.696 17.68	.991 25.17	.290 7.37	●		.140 3.56	52454
16-14 (1.04-2.62)	.033 0.84	6 M3.5	.250 6.35	.238 6.05	.664 16.87	.945 24.00	.276 7.01	●	.170 4.32	52463	52463-1
		8 M4	.281 7.14	.270 6.86	.696 17.68	.991 25.17	.290 7.37	●		-	52464-1
		10	.343 8.71	.283 7.19	.709 18.01	1.017 25.83	.303 7.70	●		52465	-

Note: "C" dimension applies from edge of metal wire barrel to centre of stud hole.

Multiple Stud Terminals

Material and Finish

Insulation:

Vinyl acc. UL 94 V-0

Terminal Body:

Copper per ASTM B-152

Plating:

Tin per ASTM B-545

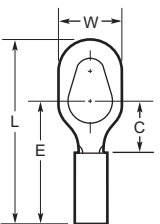

Wire Size AWG (mm ²)	Tongue Material Thickness Max.	Stud Size	Dimensions				Terminal Insulation Color	Wire Insulation Diameter Max.	Part Numbers	
			W	C Min.	E Max.	L Max.			Loose- Piece	Tape Mounted
22-16 (0.26-1.65)	.033 0.84	6-8-10	.325 8.26	.271 6.88	.691 17.55	.969 24.61	●	.125 3.18	54774-1	54774-2

Note: "C" dimension applies from edge of metal wire barrel to centre of stud hole.

Butt Splices

Material and Finish

Insulation:

Vinyl acc. UL 94 V-0

Terminal Body:

Copper per ASTM B-152

Plating:

Tin per ASTM B-545

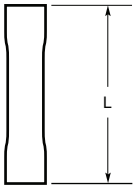

Wire Size AWG (mm ²)	Dimension L Max.	Splice Insulation Color	Wire Insulation Diameter Max.	Part Numbers	
				Loose- Piece	Tape Mounted
26-22 (0.10-0.41)	.620 15.75		.080 2.03	321026*	-
	1.065 27.05		.120 3.05	-	2-34067-1
22-16 (0.26-1.65)	1.065 27.05		.170 4.32	34243	-
	1.076 27.33		.120 3.05	324138	-
	1.076 27.33		.140 3.56	34070	-
	1.076 27.33		.140 3.56	55792-1	-
	1.065 27.05		.083 x .171 2.11 x 4.34	342033	-
	1.065 27.05		.140 3.56	34068	-
16-14 (1.04-2.62)	1.065 27.05		.140 3.56	328427	-
	1.065 27.05		.170 4.32	34071	2-34071-1
	1.065 27.05		.170 4.32	55785-1	55785-2
	1.065 27.05		.215 5.46	35244	-
	1.105 28.07		.170 4.32	-	2-34071-3
	1.065 27.05		.135 x .245 3.43 x 6.22	342043	-
12-10 (2.62-6.64)	1.160 29.46		.200 5.08	34069	-
	1.160 29.46		.230 5.84	34072	2-34072-2
	1.160 29.46		.250 6.35	34945	-
	1.200 30.48		.250 6.35	-	2-34945-2

*) Not UL or CSA Approved or Listed.

Parallel Splices

Material and Finish

Insulation:
Vinyl acc. UL 94 V-0

Splice Body:
Copper per ASTM B-152

Plating:
Tin per ASTM B-545

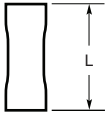

Wire Size AWG (mm ²)	Dimension L Max.	Splice Insulation Color	Wire Insulation Diameter Max.	Part Number
22-16 (0.26-1.65)	.760 19.30		.120 3.05	34131
16-14 (1.04-2.62)	.760 19.30		.170 4.32	34134
12-10 (2.62-6.64)	.843 21.41		.200 5.08	34135
	.870 22.10		.230 5.84	34136

SHUR-PLUG 3.96 mm Ø (.156)

Material and Finish

Insulation:
Vinyl acc. UL 94 V-0

Splice Body:
Copper per ASTM B-152

Plating:
Tin per ASTM B-545

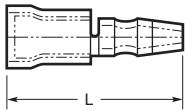

Wire Size AWG (mm ²)	Tongue Material Thickness Max.	Dimension L Max.	Terminal Insulation Color	Wire Insulation Diameter Max.	Part Number
16-14 (1.04-2.62)	.033 0.84	.800 20.32		.170 4.32	344227*

*) Not UL or CSA approved or listed.

Pre-Insulated Wire Pins

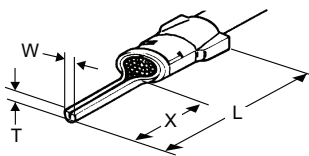

Wire Size AWG (mm ²)	Dimensions				Splice Insulation Color	Insulation Diameter Max.	Part Number
	X	W	T	L			
.010-.063 (0.25-1.6)	.264 6.7	.071 1.8	.071 1.8	.807 20.5		.146 3.7	165143
.010-.063 (0.25-1.6)	.390 9.9	.071 1.8	.071 1.8	.937 23.8		.146 3.7	165167
.039-.102 (1.0-2.6)	.264 6.7	.071 1.8	.071 1.8	.815 20.7		.193 4.9	9-165175-0
.039-.102 (1.0-2.6)	.390 9.9	.071 1.8	.071 1.8	.933 23.7		.193 4.9	9-165171-0
.106-.260 (2.7-6.6)	.390 9.9	.102 2.6	.102 2.6	1.150 29.2		.252 6.4	165085
.260-.413 (6.6-10.5)	.709 18.0	.102 2.6	.102 2.6	1.445 36.7		.260 6.6	790368-1
.260-.657 (6.6-16.7)	.709 18.0	.169 4.3	.181 4.6	1.543 39.2		.315 8.0	736066
.661-1.047 (16.8-26.6)	.787 20.0	.197 5.0	.197 5.0	1.724 43.8		.382 9.7	736067
1.051-1.669 (26.7-42.4)	.866 22.0	.197 5.0	.197 5.0	2.067 52.5		.472 12.0	736068

Application Tooling

Tooling for PLASTI-GRIP Terminals and Splices

Tool Grade	Wire Size		Description	Part Number	Instruction Sheet
	(mm ²)	(AWG)			
Service	0.4–6.0	22–10	SUPER CHAMP II	169060-8	–
	0.5–6.0	21–10	Universal Service and Maintenance Tool	1-1579004-4	–
	0.5–6.0	21–10	CRIMPAC CG (incl. Die Set)	825508-5	408-2746
Commercial	0.4–6.0	22–10	PRO-CRIMPER III (incl. Die Set) Die Set for PIDG and PLASTI GRIP	58433-3 58423-1	408-9252
	0.5–6.0	20–10	ERGOCRIMP Die Set for PIDG and PLASTI GRIP ERGOCRIMP Hand Tool Frame	539691-2 539635-1	411-18098 411-18087
	0.6–6.0	20–10	CERTI-LOK Die Set for PIDG and PLASTI GRIP CERTI-LOK Hand Tool Frame	169404 169400	408-6765 411-1115
Premium	0.15–0.40	26–22		46121 or 169485	408-1559
	0.4–1.5	22–16	Double Action Hand Tool (DAHT)	47386	408-1559
	1.5–2.5	16–14		47387	408-1559
	0.4–6.0	22–10	TETRA-CRIMP Hand Tool	59824-1	408-2823
	4.0–6.0	12–10	Heavy Head Hand Tool (HHHT)	59239-4	408-1261

Find the latest Tooling and Equipment options for your applications at
<http://www.tooling.tycoelectronics.com/europe/handtool.stm>

Cross Reference for Small Packaging

Standard Package	Description	Small Pack Order Number	Primary Package Quantity	Minimum Order Quantity
160214	PLASTI-GRIP SHUR PLUG	2-1377174-7	50	1,000
34071	PLASTI-GRIP BUTT SPLICE	5-1377173-3	100	2,000
321026	PLASTI-GRIP BUTT SPLICE	5-1377173-1	100	2,000
34072	PLASTI-GRIP BUTT SPLICE	5-1377173-4	50	1,000
34070	PLASTI-GRIP BUTT SPLICE	5-1377173-2	100	2,000
131444	PLASTI-GRIP WIRE PIN ASSY	4-1377173-8	100	2,000
131443	PLASTI-GRIP WIRE PIN ASSY	4-1377173-3	100	2,000
131445	PLASTI-GRIP WIRE PIN ASSY	5-1377173-0	50	1,000
165075	PLASTI-GRIP WIRE PIN	4-1377173-5	100	2,000
9-165075-0	PLASTI-GRIP WIRE PIN	4-1377173-4	100	2,000
165143	PLASTI-GRIP WIRE PIN	4-1377173-1	100	2,000
165171	PLASTI-GRIP WIRE PIN	4-1377173-7	100	2,000
9-165171-0	PLASTI-GRIP WIRE PIN	4-1377173-6	100	2,000
165085	PLASTI-GRIP WIRE PIN	4-1377173-9	100	2,000
165167	PLASTI-GRIP WIRE PIN	4-1377173-2	100	2,000
34132	PLASTI-GRIP PARALLEL SPLICE	5-1377173-5	100	2,000
34134	PLASTI-GRIP PARALLEL SPLICE	5-1377173-6	50	1,000
34136	PLASTI-GRIP PARALLEL SPLICE	5-1377173-7	50	1,000
160136	PLASTI-GRIP RING TONGUE	5-1377175-6	100	2,000
160124	PLASTI-GRIP RING TONGUE	1-1377173-3	50	1,000
34140	PLASTI-GRIP RING TONGUE	9-1377172-2	100	2,000
34157	PLASTI-GRIP RING TONGUE	1377173-2	100	2,000
34141	PLASTI-GRIP RING TONGUE	9-1377172-3	100	2,000
34142	PLASTI-GRIP RING TONGUE	9-1377172-4	100	2,000
34158	PLASTI-GRIP RING TONGUE	1377173-3	100	2,000
34160	PLASTI-GRIP RING TONGUE	1377173-4	100	2,000
34853	PLASTI-GRIP RING TONGUE	1377173-9	50	1,000
34145	PLASTI-GRIP RING TONGUE	9-1377172-5	100	2,000
34148	PLASTI-GRIP RING TONGUE	9-1377172-6	100	2,000
130102	PLASTI-GRIP RING TONGUE	1377173-5	100	2,000
160292	PLASTI-GRIP RING TONGUE	1-1377173-0	50	1,000
130014	PLASTI-GRIP RING TONGUE	9-1377172-7	100	2,000
34162	PLASTI-GRIP RING TONGUE	1377173-6	100	2,000
130126	PLASTI-GRIP RING TONGUE	1377173-7	100	2,000

Cross Reference for Small Packaging (continued)

Standard Package	Description	Small Pack Order Number	Primary Package Quantity	Minimum Order Quantity
160294	PLASTI-GRIP RING TONGUE	1-1377173-1	50	1,000
165035	PLASTI-GRIP RING TONGUE	5-1377175-4	50	1,000
34150	PLASTI-GRIP RING TONGUE	9-1377172-9	100	2,000
130054	PLASTI-GRIP RING TONGUE	9-1377172-8	100	2,000
34163	PLASTI-GRIP RING TONGUE	1377173-8	100	2,000
160296	PLASTI-GRIP RING TONGUE	1-1377173-2	50	1,000
34151	PLASTI-GRIP RING TONGUE	1377173-1	100	2,000
324165	PLASTI-GRIP SPADE FLAG	3-1377173-3	100	2,000
322249	PLASTI-GRIP SPADE FLAG	2-1377173-1	100	2,000
160212	PLASTI-GRIP SPADE FLAG	3-1377173-4	100	2,000
324172	PLASTI-GRIP SPADE FLAG	3-1377173-9	50	1,000
324169	PLASTI-GRIP SPADE FLAG	2-1377173-2	100	2,000
160213	PLASTI-GRIP SPADE FLAG	3-1377173-5	100	2,000
165134	PLASTI-GRIP SPADE FLAG	4-1377173-0	50	1,000
328516	PLASTI-GRIP SPADE FLAG	2-1377173-3	100	2,000
165010	PLASTI-GRIP SPADE	2-1377173-4	100	2,000
165004	PLASTI-GRIP SPADE	1-1377173-4	100	2,000
34165	PLASTI-GRIP SPADE	2-1377173-7	100	2,000
106730	PLASTI-GRIP SPADE	2-1377173-5	100	2,000
322994	PLASTI-GRIP SPADE	2-1377173-6	100	2,000
34154	PLASTI-GRIP SPADE	1-1377173-7	100	2,000
320665	PLASTI-GRIP SPADE	1-1377173-6	100	2,000
327043	PLASTI-GRIP SPADE	1-1377173-5	100	2,000
34166	PLASTI-GRIP SPADE	3-1377173-0	100	2,000
165012	PLASTI-GRIP SPADE	2-1377173-8	100	2,000
326741	PLASTI-GRIP SPADE	2-1377173-9	100	2,000
165015	PLASTI-GRIP SPADE	3-1377173-6	50	1,000
34155	PLASTI-GRIP SPADE	1-1377173-8	100	2,000
165008	PLASTI-GRIP SPADE	1-1377173-9	100	2,000
160171	PLASTI-GRIP SPADE	3-1377173-1	100	2,000
165017	PLASTI-GRIP SPADE	3-1377173-7	50	1,000
34156	PLASTI-GRIP SPADE	2-1377173-0	100	2,000
130568	PLASTI-GRIP SPADE	3-1377173-2	100	2,000
165019	PLASTI-GRIP SPADE	3-1377173-8	50	1,000